



Plum Tree Cottage, 4 The Old Orchard, Pool In Wharfedale, LS21 1RY

Price Guide £385,000



3



2



2



C



Floor Plan

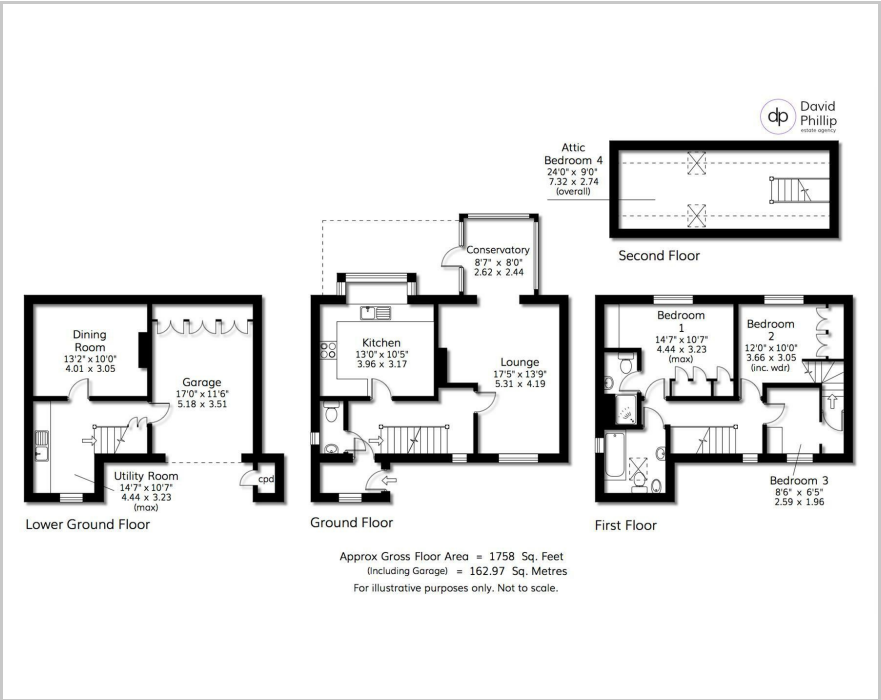

Area Map



Accommodation

- A Quietly Situated Cottage-Style Stone Built Town House
- Three Bedrooms Plus Loft Room, Two Bathrooms, on Four Floors
- Fitted Kitchen, Lounge with Wood Burner
- Conservatory and External Covered Canopy
- Sought After Near Village Centre Cul-de-Sac
- Integral Garage, Parking, Dining Room and Utility
- Solar Roof Panels And Battery Storage
- Offered With Vacant Possession, No Chain
- Energy Performance Certificate (EPC) Rating C
- Council Tax Band D

Viewing

Please contact our David Phillip Estate Agents Office on 01134 676 400 if you wish to arrange a viewing appointment for this property or require further information.

Energy Efficiency Graph

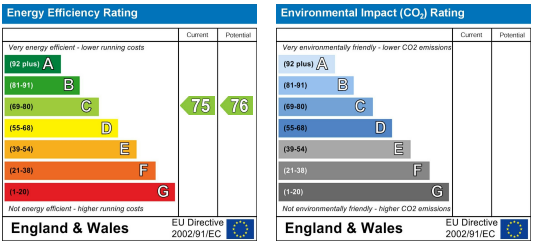

These particulars, whilst believed to be accurate are set out as a general outline only for guidance and do not constitute any part of an offer or contract. Intending purchasers should not rely on them as statements of representation of fact, but must satisfy themselves by inspection or otherwise as to their accuracy. No person in this firms employment has the authority to make or give any representation or warranty in respect of the property.